

AGALINIS ESTATES - GATED COMMUNITY ON SEAVIEW ROAD - DUPLEX LOT 10

Midland East, Cayman Islands

MLS# 417788

CI\$176,820

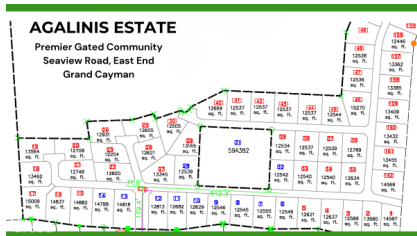

Sloane Rhulen
sloane@rhulens.com

Welcome to Agalinis Estates, a premier gated community on Seaview Road, East End, featuring prime residential lots for sale. Just half a mile up from the Frank Sound Junction, lots will be cleared, filled, and equipped with underground utilities, making them ready for construction. These lots are ideal for single-family homes or duplexes providing more flexibility in home design. This phased development will feature 164 lots spreading over 101 acres, with 23 acres dedicated to preserving the Agalinis Kingsii, home to the rare endemic plant of the same name. Residents will have convenient access to nearby beaches, Clifton Hunter High School, and just 2 miles from Health City. This development offers a peaceful retreat from the hustle and bustle of Cayman, providing a breath of fresh air where you can truly feel at home. With introductory affordable pricing, this is an excellent investment opportunity and a perfect way to enter the property market. The community will be safeguarded for years to come, with robust covenants, ensuring the security and appreciation of your property value. Get in touch for more details.

Essential Information

Type Land (For Sale)	Status Pen/Con	MLS 417788	Listing Type Agriculture
--------------------------------	--------------------------	----------------------	------------------------------------

Key Details

Width 1.00	Depth 1.00	Block 59A	Parcel 383-L10
----------------------	----------------------	---------------------	--------------------------

Additional Features

Block 59A	Parcel 383-L10	Views Garden View, Inland	Zoning Low Density residential
---------------------	--------------------------	-------------------------------------	--

Road Frontage 1	Soil Other
---------------------------	----------------------