

LARGE OCEAN VIEW PARCELS- 3 IN 1

East End, Cayman Islands

MLS# 420687

CI\$575,000

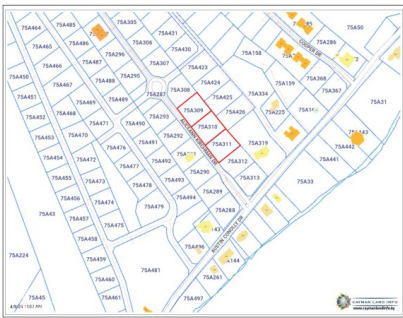



Sloane Rhulen
sloane@rhulens.com

Tucked just beyond the iconic East End Lighthouse, these three adjoining parcels present a rare opportunity to secure a prime position within one of the district’s most thoughtfully planned and up-and-coming communities. With paved roads, quality infrastructure, and generously sized lots throughout, this subdivision is already setting the tone for a well-established and desirable neighborhood. Each parcel spans approximately one-third of an acre, offering ample space to design and build a substantial home while still enjoying privacy and open surroundings. Notably, these are among the highest elevation lots in the area- sitting between 20–24 feet above sea level- providing a true “high and dry” setting, which is a significant advantage for coastal living in Cayman. Just steps away, you’ll find a beautiful stretch of sandy beachfront with stunning ocean views, giving you the best of both worlds: elevated positioning with easy access to the water. East End continues to grow in popularity for those seeking a quieter, more relaxed lifestyle, and this particular pocket stands out for its setting, infrastructure, and overall appeal. It offers a balance of tranquility and value, making it an excellent option for both end users and investors looking to secure land in an area with strong future potential. The owner may also consider selling the parcels individually for the right opportunity, adding flexibility for a range of buyers. 3 lots combined are .87 acres of great sea views. Call to find out more or view in person!

Essential Information

Type Land (For Sale)	Status Current	MLS 420687	Listing Type Agriculture
--------------------------------	--------------------------	----------------------	------------------------------------

Key Details

Width 300.00	Depth 100.00	Block 75A	Parcel 309,310,311
------------------------	------------------------	---------------------	------------------------------

Additional Features

Block 75A	Parcel 309, 310, 311	Views Beach View, Ocean View	Zoning Medium Density Residential
---------------------	--------------------------------	--	---

Road Frontage
300